

Use and Maintenance Technical Manual



Scan QR Code
and visit the
website to see
more details
about our
products



Emme Antincendio S.r.l.
www.emme-italia.com

Via del Molino, 40 - 52010 Corsalone (AR) - Italy - info@emme-italia.com - Tel. +39.0575.511320

Other branches Emme Antincendio s.r.l. in Italy : Milano - Padova - Reggio Emilia - Roma - P.IVA/ C.F. 11208251006 - R.E.A. FI-632545

DOLOMITI 6 - 22063-3 : Portable Fire Extinguisher, 6 L Foam



SUITABLE ON
POLAR SOLVENTS

FROST RESISTANCE
(UP TO -30°C)

- **CYLINDER**
In high-strength alloy steel, deep drawing, external powder painting Red Ral 3000.
- **EXTINGUISHING AGENT**
Water-based foam.
- **PROPELLANT**
Dehumidified air or nitrogen (N₂).
- **VALVE**
CPF M. 30x1.5, brass body, with anti-corrosion treatment.
- **USE**
A B F fire rating (solid materials, flammable liquids, cooking oils).

© REPRODUCTION IS PROHIBITED

Note: image is for illustrative purpose only, the product purchased can has some difference

6 L foam fire extinguisher, temperature range from -30°C to +60°C, manufactured in accordance to **UNI EN 3-7**, approved Marine Equipment Directive **MED 2014/90/EU**, certified according to the directive for pressure equipment **PED 2014/68/EU**.

Quality Product certification guaranteed by Bureau Veritas Italia.

Suitable for use on fire involving electrical voltages up to 1'000 V, at a distance of 1 meter.

APPROVED/CERTIFIED FIRE EXTINGUISHER:

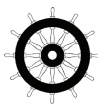

FIRE RATING :



34



233



75

File name	Type of document	Fire Extinguisher Model	Date	Rele.	Check	Rev.	Pag.
22063-3 Dolomiti 6_Technical manual	Use and Maintenance technical manual	22063-3 Dolomiti 6	04/01/2022	M.R		1	1 di 8

DOLOMITI 6 - 22063-3 : Portable Fire Extinguisher, 6 L Foam

TECHNICAL SPECIFICATIONS

FIRE RATING	34 A 233 B 75 F
EXTINGUISHING AGENT	Foam EW-30 (100 % Premix MG6 -30)
PROPELLANT	Dehumidified air or Nitrogen (N ₂), 15 bar at 20°C
TEMPERATURE RANGE	-30°C / +60°C
NOMINAL CHARGE	6 Liters
FULL WEIGHT	~ 10,45 Kg
DIMENSIONS	Height (base - valve) 540 +/- 5 mm Diameter (cylinder) 160 +/- 2 mm
DISCHARGE TIME	~ 27,6 seconds
VALVE TIGHTENING TORQUE	Minimum 45 Nm, Maximum 68 Nm
CYLINDER PRESSURE TEST	PT 27 bar
CYLINDER VOLUME	7,5 L.
SAFETY DEVICE	Set between 20 and 24 bar
CYLINDER MATERIAL	Alloy steel
EXTERNAL /INTERNAL TREATMENT	Sandblast and powder painting, Red Ral 3000 colour / Plastic coating

PACKAGING

(Note: the packaging quantities and measurements are indicative and can be subject at changes)

STANDARD

Maximum nr. 100 pieces for pallet
(44 pieces for box, max 2 boxes for pallet)
(12 pieces. single packaging)
Pallet dimensions 100x120x160(h) cm

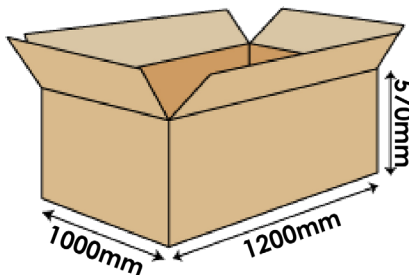

ON REQUEST: SINGLE PACKAGING

- maximum 64 pieces on pallet 100x120
- minimum 48 pieces on pallet 80x120

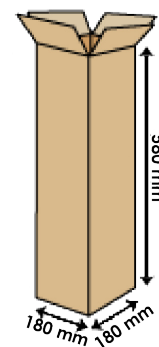

TRANSPORT DISPOSAL

Land transport : Exemption for the purposes of ADR disposal 594

Ship Transport : IMDG Code - UN 1044 class 2.2 Fire Extinguishers

File name	Type of document	Fire Extinguisher Model	Date	Rele.	Check	Rev.	Pag.
22063-3 Dolomiti 6_Technical manual	Use and Maintenance technical manual	22063-3 Dolomiti 6	04/01/2022	M.R		1	2 di 8

DOLOMITI 6 - 22063-3 : Portable Fire Extinguisher, 6 L Foam

COMPONENTS AND SPARE PARTS LIST

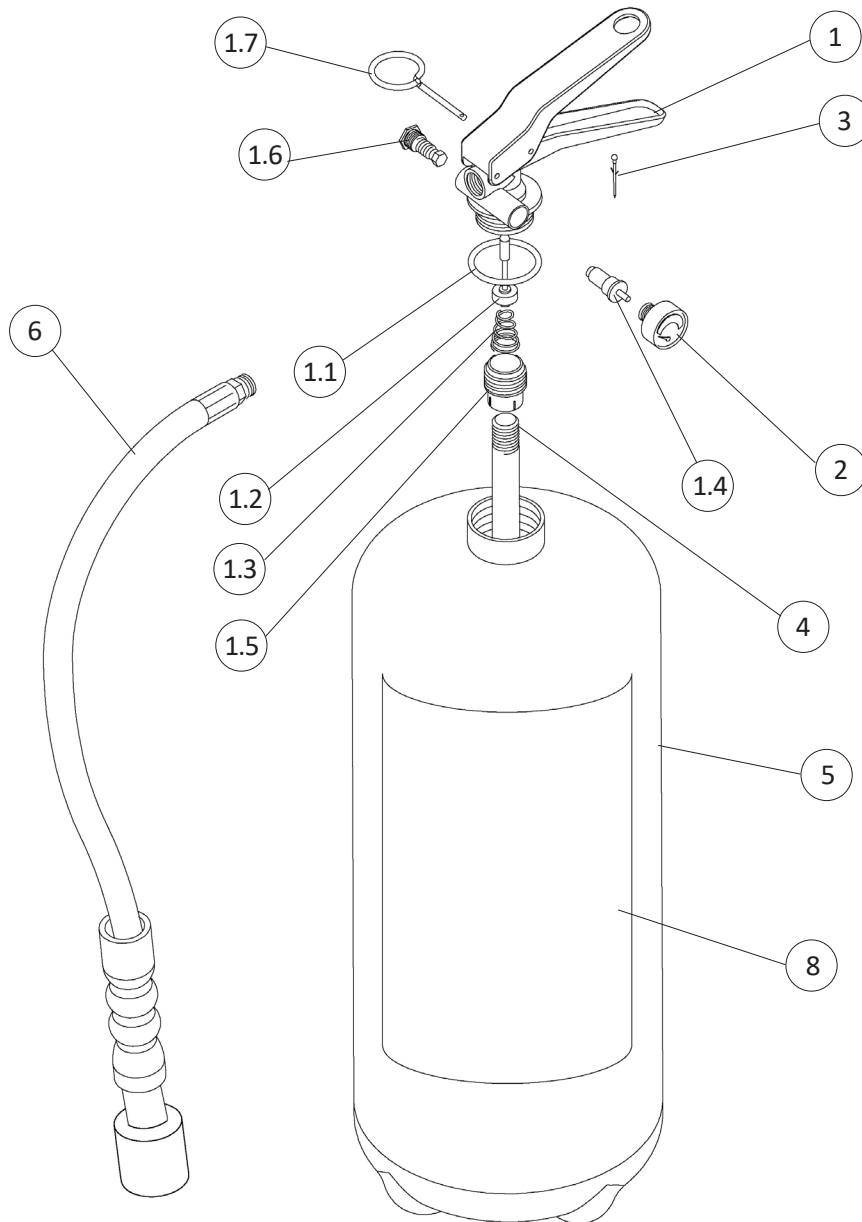

Table 1

NUM.	DESCRIPTION	CODE	NUM.	DESCRIPTION	CODE
1	Valve M. 30x1.5	0212CS	5	Cylinder	0112
1.1	O-ring valve	0201C	6	Hose with dispensing nozzle	0293
1.2	Valve stem	0242C	7	Label	1577-3
1.3	Internal spring of the valve	0251C	OPTIONAL	Iron marine bracket red painting	0316
1.4	Test valve for pressure gauge	1163C	OPTIONAL	Stainless steel marine bracket	1464
1.5	Dip tube holder	0253C		Foam refill (6 L. bottle, ready to use)	1623
1.6	Safety device	0261C			
1.7	Safety pin	0284			
2	Pressure gauge	1576			
3	Safety pin seal (green)	0285			
4	PVC dip tube	0154			

The spare part at number 1 includes already all others components indicated from 1.1 to 1.7

File name	Type of document	Fire Extinguisher Model	Date	Rele.	Check	Rev.	Pag.
22063-3 Dolomiti 6_Technical manual	Use and Maintenance technical manual	22063-3 Dolomiti 6	04/01/2022	M.R		0	3 di 8

Maintenance periods for efficiency guarantee, methods and subjects accredited for maintenance

1) GENERAL REQUIREMENTS

All Fire Fighting Fire Extinguishers produced by Emme Antincendio must be installed, inspected and maintained in accordance with the following manual and with the rules in force in the country of destination.

All fire extinguishers must be recharged after partial use with original spare parts.

Every ordinary / extraordinary maintenance operation must be carried out using original spare parts and compliant with the declared certified prototype. The described below maintenance operations must be carried out by recognized personnel qualified by the company Emme Antincendio.

Fire extinguishers are classified into two categories that provide for specific construction standards:

- portable fire extinguishers: fire extinguishers designed to be transported and operated by hand, with a mass not exceeding 20 kg under operating conditions. Reference standard: EN 3-7
- wheeled fire extinguishers: wheel fire extinguishers designed to be transported and operated by hand, with a mass greater than 20 kg. Reference standards: EN 1866-1

Moreover, in relation to the extinguishing agent contained in them, they are identified in:

- water based fire extinguishers including foam extinguishers;
- powder fire extinguishers;
- carbon dioxide fire extinguishers;
- clean agent extinguishers

2) REFERENCE RULES

Fire Extinguishers produced by Emme Antincendio are manufactured in compliance with the following rules:

- EN 3-7: 2008 Portable fire extinguishers;
- EN 1866-1: 2008 Wheeled fire extinguishers;
- PED Directive 2014/68/EU pressure equipment;
- MED Directive 2014/90/EU devices for marine use (only for products bearing the relative MED certification mark, see pag 1 of this document)

3) INSTALLATION

- 1) Install the fire extinguisher with the appropriate bracket, with the handle at a maximum recommended height of 110 cm.
- 2) When installed in a vehicle the fire extinguisher must be held in a specific truck bracket.
- 3) Do not expose the fire extinguisher to the atmospheric agents or chemicals agents.
(Note: in these cases protect the fire extinguisher with a special cabinet or protective cover.)
- 4) Do not expose the fire extinguisher to the direct sunlight.
- 5) Verify that the gauge pressure indicator is inside the green area.
- 6) Keep children away from fire extinguisher.
- 7) For Marine equipment or outdoor installation we recommend use of cover or cabinet.

4) MODALITY AND PRECAUTIONS FOR THE USE

- 1) Follow the operating Instructions printed on the main fire extinguisher label

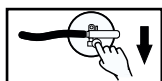

1) REMOVE SAFETY PIN



2) HOLD THE HOSE

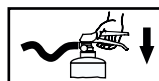

3) SQUEEZE GRIP LEVER



4) AIM THE JET AT BASE OF FIRE

- 2) Do not through the fire extinguisher on to the direct flames.
- 3) This fire extinguisher is a pressurized vessel and must not be pierced, dented or subjected to external damage.
- 4) Do not direct the jet on the people.

File name	Type of document	Fire Extinguisher Model	Date	Rele.	Check	Rev.	Pag.
S6 SUPER - 22064_Technical manual	Use and Maintenance technical manual	S6 SUPER - 22064	04/01/2022	M.R		0	4 di 8

DOLOMITI 6 - 22063-3 : Portable Fire Extinguisher, 6 L Foam

5) STEPS AND FREQUENCY RELATED TO MAINTENANCE OPERATIONS

(For stored pressure fire extinguishers)

Note: The user have to complies to the national or international rules, if they are more restrictive of the below table

Table 2

Ref.	Periodicity	Step	Operations
5.1	12 Months	Ispection	Check internal pressure using an independent tool
5.2	30 Months	Maintenance	Change the extinguishing agent.
	5 Years		Check the thread of the valve body and if a non-compliance is detected, replace it.
5.3	10 Years	Hydrotest Cylinder	Check the conservation status and perform the hydraulic test of the cylinder with suitable tool. Is recommended the replacement of dispensing valve
5.4	*20 Years		Is recommended the replacement of the fire extinguisher

* If it located in particular environments the timing can be reduced.

(it is recommended to reduce to 10 years)

N.B. : All the operations must be calculated from the date of placing on the market.

For the hydraulic test refer to the date stamped on the tank.

5.1) Inspection Steps

1	Remove the fire extinguisher from the bracket and check the fixing stability
2	Check the internal pressure with an independent tool
3	Check the safety seal and the safety pin
4	Remove the hose and check the correct internal passage with compressed air
5	Record the inspection activity on the maintenance tag and on the fire protection register

5.2) Maintenance Steps

1	Remove the fire extinguisher from the bracket and check the fixing stability. Check the marking label and replace it if damaged
2	Discharge the fire extinguisher, comply at rules for a correct disposal
3	Remove the dispensing valve.
4	Check inside the cylinder and sure that the protective plastic coating is intact and that no shows corrosion signs. For the hose, check the internal passage with compressed air
5	Recharge the fire extinguisher with new extinguishing agent
6	Valve with brass body (anti-corrosion treat.) Check the thread of valve body and if damaged replace with a new valve. For valves without safety device, replacement is recommended in any case. Screw the valve with a tightening torque as shown : min. 45 Nm - max 68 Nm
7	Pressurize the fire extinguisher with dehumidified air or nitrogen (15 bar at 20 °C) and check for leaks
8	Reset the safety pin and secure it with safety seal, screw the hose
9	Record the inspection activity on the maintenance tag and on the fire protection register

© REPRODUCTION IS PROHIBITED

File name	Type of document	Fire Extinguisher Model	Date	Rele.	Check	Rev.	Pag.
22063-3 Dolomiti 6_Technical manual	Use and Maintenance technical manual	22063-3 Dolomiti 6	04/01/2022	M.R		0	5 di 8

DOLOMITI 6 - 22063-3 : Portable Fire Extinguisher, 6 L Foam

5.3) Hydraulic test step













At least every 10 years from the production date the fire extinguisher must be overhauled by a hydraulic pressure test in accordance with the pressure values "PT" stamped on the cylinder.

1	Remove the fire extinguisher from the bracket and check the fixing stability. Check the marking label and replace it if damaged	
2	Discharge the fire extinguisher, comply at rules for a correct disposal	
3	Remove the dispensing valve	
4	Check inside the cylinder and sure that the protective plastic coating is intact and that no shows corrosion signs. For the hose, check the internal passage with compressed air	
5	Hydraulic test of the cylinder with suitable tool: maintain hydraulic pressure at "PT" for 30 seconds and proceed with depressurization. Check that the cylinder does not show any deformation, breakage or stability anomalies	
6	Proceed with the cleaning and removal of any residues	
7	Recharge the fire extinguisher with new extinguishing agent	
8	Valve with brass body (anti-corrosion treat.)	Is recommended the replacement of dispensing valve. Screw the valve with a tightening torque as shown : min. 45 Nm - max 68 Nm
9	Pressurize the fire extinguisher with dehumidified air or nitrogen (15 bar at 20 °C) and check for leaks	
10	Reset the safety pin and secure it with safety seal, screw the hose	
11	Record the inspection activity on the maintenance tag and on the fire protection register	

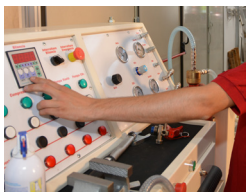
File name	Type of document	Fire Extinguisher Model	Date	Rele.	Check	Rev.	Pag.
S6 SUPER - 22064_Technical manual	Use and Maintenance technical manual	S6 SUPER - 22064	04/01/2022	M.R		0	6 di 8

DOLOMITI 6 - 22063-3 : Portable Fire Extinguisher, 6 L Foam

Executive details Inspection steps, Maintenance, Hydraulic test

	<p>1 - Remove the fire extinguisher from the bracket; check marking label and replace it if damaged, check stability of the bracket, cleaning, general conditions</p>	<p>2 - Unload completely the fire extinguisher , comply at local rules for the correct disposal.</p>
 	<p>3 - Remove the valve.</p>	<p>4 - Perform an internal check of the cylinder with an inspection lamp. Verify that the hose allows a correct air passage and replace it if necessary. Replace the o-ring, clean and grease the parts.</p>  
	<p>5 - Hydraulic cylinder test: maintain hydraulic pressure at "PT" for 30 seconds and proceed with depressurization</p>	<p>6 - Proceed with the cleaning and removal of any residues</p>
	<p>7 - Recharge the fire extinguisher with extinguishing agent</p>	<p>8 - Reinstall the dip tube and dispensing valve. Perform the operation with suitable torque wrench, making sure you have set the correct tightening torque</p> 
 	<p>9 - Pressurize the fire extinguisher with a suitable pneumatic gripper and check for any pressure loss using a "leak detector"; to secure the device with safety pin and safety seal</p>	<p>10 - Screw the dispensing hose, check for the correct pressure gauge reading</p> 
	<p>11 - Record the inspection activity on the maintenance tag and on the fire protection register</p>	

Note: images are for illustrative purpose only.

File name	Type of document	Fire Extinguisher Model	Date	Rel.	Check	Rev.	Pag.
22063-3 Dolomiti 6_Technical manual	Use and Maintenance technical manual	22063-3 Dolomiti 6	04/01/2022	M.R		0	7 di 8

DOLOMITI 6 - 22063-3 : Portable Fire Extinguisher, 6 L Foam

5.4) Twenty-year control

End-of-life fire extinguishers must be disposed in accordance with local waste management rules. Before disposal or disassembly, the fire extinguisher MUST BE DEPRESSURIZED by a competent person. Fire extinguishers should always be disposed of through an approved disposal company and in accordance with applicable local and national codes.

* If the fire extinguisher is located in particular environments, the "life time" timing can be reduced (see table 2 at point 5.4).

6) SPARE PARTS LIST AND MAINTENANCE TOOLS

6.1) Spare parts list

For the spare parts list see the table 1 at pag 3.
For more details see web site www.emme-italia.com

6.2) Inspection/Maintenance Tools

For a complete list of recommended tools see web site www.emme-italia.com.
It is recommended to use instruments with controlled calibration and periodically verified (at least every 12 months) with certified sample instrument.

File name	Type of document	Fire Extinguisher Model	Date	Rele.	Check	Rev.	Pag.
S6 SUPER - 22064_Technical manual	Use and Maintenance technical manual	S6 SUPER - 22064	04/01/2022	M.R		0	8 di 8