

Technical Manual



www.emme-italia.com

Via del Molino, 40 - 52010 Corsalone (AR) - Italy - info@emme-italia.com - Tel. +39.0575.511320
P.IVA/ C.F. 11208251006 - R.E.A. AR-159122

GW6PX 22066-710 : Portable Fire Extinguisher, 6 L Foam



FLUORINE FREE

- **CYLINDER**
Stainless steel, 3 pieces drawing, external powder painting Red Ral 3000.
- **EXTINGUISHING AGENT**
Fluorine free foam, water based.
- **PROPELLANT**
Nitrogen (N₂).
- **VALVE**
M. 30x1.5, brass body, levers with green painting Ral 6018.
- **USE**
A B F fire rating (solid materials, flammable liquids, cooking oils).

REPRODUCTION IS PROHIBITED

Note: image is for illustrative purpose only, the product purchased can has some difference

6 L foam fire extinguisher, temperature range from +5°C to +60°C, manufactured in accordance to **UNI EN 3-7**, approved Marine Equipment Directive **MED 2014/90/EU**, certified according to the directive for pressure equipment PED 2014/68/EU. Manufactured according to productions checks as agreed with **EN 3-10**. Quality Product certification guaranteed by Bureau Veritas Italia.

Suitable for use on fire involving electrical voltages up to 1'000 V, at a minimum distance of 1 meter.

APPROVED/CERTIFIED FIRE EXTINGUISHER:

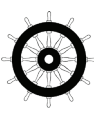

FIRE RATING :



27



144



40

File name	Type of document	Fire Extinguisher Model	Date	Rele.	Check	Rev.	Pag.
22066-710_GW6PX_Technical manual	Technical manual	GW6PX_22066-710	30/05/25	S.R.		3	1/3

GW6PX 22066-710 : Portable Fire Extinguisher, 6 L Foam

- **INSTALLATION** The installation must be carried out in accordance with the provisions in force in the country where the device is used.
- **USE** The commissioning and maintenance activities for maintaining efficiency must be carried out in accordance with the document **PSP_1_ENG** by qualified technical personnel and in compliance with the regulations in force in the country of use.
- **MAINTENANCE** Any tampering or intervention carried out by unqualified personnel will void the product warranty.
It is recommended to place the device in a dry place protected from atmospheric agents.

TECHNICAL SPECIFICATIONS

FIRE RATING	27 A 144 B 40 F
EXTINGUISHING AGENT	100% Green Wave Premix
PROPELLANT	Nitrogen (N ₂), 15 Bar at 20°C
TEMPERATURE RANGE	+5°C / +60°C
NOMINAL CHARGE	6 Liters
FULL WEIGHT	~ 8,70 Kg
DIMENSIONS	Height 530 (base - valve) +/- 5 mm Diameter (cylinder) 160 +/- 2 mm
DISCHARGE TIME	~ 18,8 seconds
CYLINDER PRESSURE TEST	PT 27 bar
CYLINDER VOLUME	7,80 L
SAFETY DEVICE	Set between 20 and 26 bar
CYLINDER MATERIAL	Stainless steel Aisi 304
TREATMENT	Outside: Sandblast and powder painting Ral 3000

PACKAGING

(Note: quantities and measurements are indicative and can be subject at changes)

STANDARD

Maximum nr. 100 pieces for pallet
(44 pieces for box, max 2 boxes for pallet)
(12 pieces. single packaging)
Pallet dimensions 100x120x160(h) cm

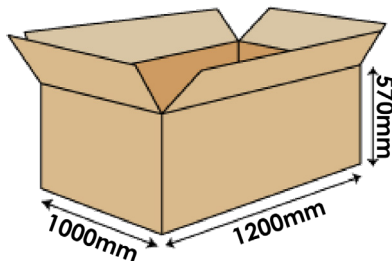

ON REQUEST: SINGLE PACKAGING

- maximum 64 pieces on pallet 100x120
- maximum 48 pieces on pallet 80x120

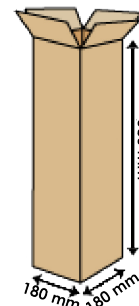

TRANSPORT DISPOSAL

Land transport : Exemption for the purposes of ADR disposal 594
Ship Transport : IMDG Code - UN 1044 class 2.2 Fire Extinguishers

File name	Type of document	Fire Extinguisher Model	Date	Rele.	Check	Rev.	Pag.
22066-710_GW6PX_Technical manual	Technical manual	GW6PX_22066-710	30/05/25	S.R.		3	2/3

GW6PX 22066-710 : Portable Fire Extinguisher, 6 L Foam

COMPONENTS AND SPARE PARTS LIST

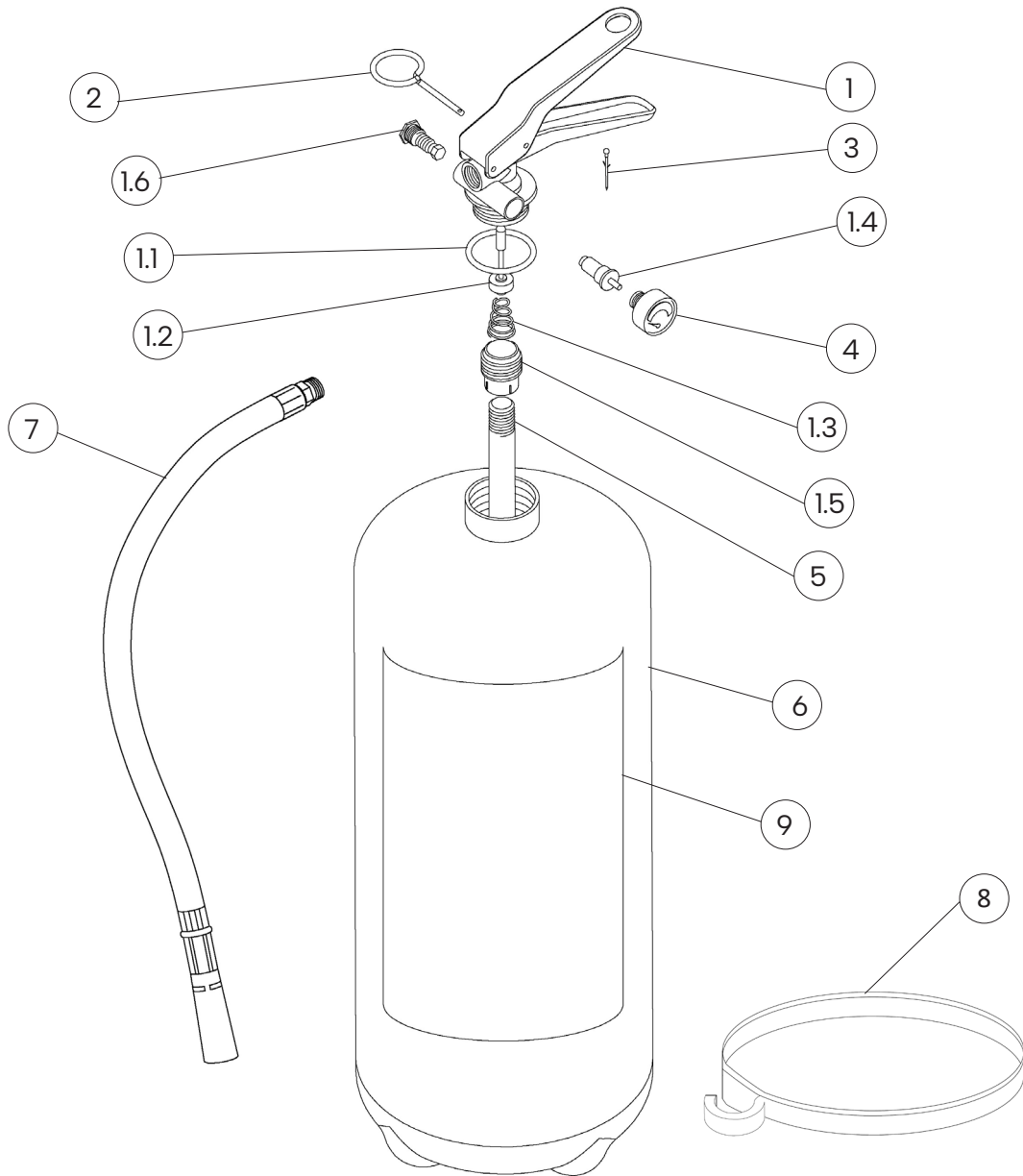

NUM.	DESCRIPTION	CODE
1	Valve M. 30x1.5	0212FV
1.1	O-ring valve	0201R
1.2	Valve stem	0242R
1.3	Internal spring of the valve	0251R
1.4	Test valve for pressure gauge	1163
1.5	Dip tube holder	0253R
1.6	Safety device	0261R
2	Safety pin	0282-1
3	Safety pin seal	0285

NUM.	DESCRIPTION	CODE
4	Pressure gauge	1576
5	PVC dip tube with filter	0154F
6	Cylinder	1849
7	Hose with dispensing nozzle	2296-2V
8	Stop hose ring	0301
9	Label	0083-710

The spare part at number 1 includes already all others components indicated from 1.1 to 1.6

File name	Type of document	Fire Extinguisher Model	Date	Rele.	Check	Rev.	Pag.
22066-710_GW6PX_Technical manual	Technical manual	GW6PX_22066-710	30/05/25	S.R.		3	3/3