

Technical Manual



www.emme-italia.com

Via del Molino, 40 – 52010 Corsalone (AR) – Italy – info@emme-italia.com – Tel. +39.0575.511320
P.IVA/ C.F. 11208251006 – R.E.A. AR-159122

16508-52 : Wheeled Fire Extinguisher, 50 Kg ABC Powder



- **CYLINDER**
In high-strength alloy steel, external powder painting Red Ral 3000.
- **EXTINGUISHING AGENT**
ABC powder – Map 40% .
- **PROPELLANT**
Auxiliary pressure.
Fire extinguisher pressurized at moment of use with CO₂ external cylinder.
- **CAP**
Brass, 2".
- **USE**
A B C fire rating
(solid materials, flammable liquids, flammable gas.
- **BRACKET**
Chassis on wheels, welded at the cylinder, red painting Ral 3000.

Note: image is for illustrative purpose only, the product purchased can has some difference

50 Kg powder wheeled fire extinguisher, auxiliary pressure, temperature range from -30°C to +60°C, manufactured in accordance to **UNI EN 1866-1**, approved Marine Equipment Directive **MED 2014/90/EU**, certified according to the directive for pressure equipment PED 2014/68/EU.

Quality Product certification guaranteed by Bureau Veritas Italia.

Suitable for use on fire involving electrical voltages up to 1'000 V, at a distance of 1 m.

APPROVED/CERTIFIED FIRE EXTINGUISHER:

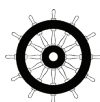

**FIRE
RATING :**



✓



IV



✓

File name	Type of document	Fire Extinguisher Model	Date	Rele.	Check	Rev.	Pag.
16508-52_ technical manual	technical manual	16508-52	27/05/2025	S.R		3	1/3

REPRODUCTION IS PROHIBITED

16508-52 : Wheeled Fire Extinguisher, 50 Kg ABC Powder

- **INSTALLATION** The installation must be carried out in accordance with the provisions in force in the country where the device is used. The commissioning and maintenance activities for maintaining efficiency must be carried out in accordance with the document **CPA_I_ENG** by qualified
- **USE**
- **MAINTENANCE** technical personnel and in compliance with the regulations in force in the country of use.

Any tampering or intervention carried out by unqualified personnel will void the product warranty.

It is recommended to place the device in a dry place protected from atmospheric agents.

TECHNICAL SPECIFICATIONS

FIRE RATING	A IV B C
EXTINGUISHING AGENT	ABC powder "Emme Powder 40" – MAP 40 % (QFIRE 40 – Quimica 21, S.L.)
PROPELLANT	1,2 Kg di CO ₂
TEMPERATURE RANGE	-30°C / +60°C
NOMINAL CHARGE	50 Kg
FULL WEIGHT	~ 85 Kg
DIMENSIONS	Height 1100 +/- 10 mm; Width 490 +/- 10 mm Depth 560 +/- 10 mm
DISCHARGE TIME	~ 50,9 seconds
CYLINDER PRESSURE TEST	PT 30 bar
CYLINDER VOLUME	62 L
SAFETY DEVICE	Set between 21 and 26 bar
CYLINDER MATERIAL	Steel alloy
TREATMENT	Outside : Sandblast and powder painting Ral 3000

PACKAGING

(Note: quantities and measurements are indicative and can be subject at changes)

STANDARD
Maximum nr. 4 pieces for pallet
Pallet dimensions 100x120x135(h) cm

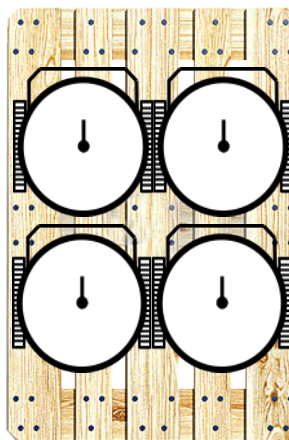

TRANSPORT DISPOSAL

Land transport : Exemption for the purposes of ADR disposal 594
Ship Transport : IMDG Code – UN 1044 class 2.2 Fire Extinguishers

File name	Type of document	Fire Extinguisher Model	Date	Rele.	Check	Rev.	Pag.
16508-52_ technical manual	technical manual	16508-52	27/05/2025	S.R		3	2/3

16508-52 : Wheeled Fire Extinguisher, 50 Kg ABC Powder

COMPONENTS AND SPARE PARTS LIST

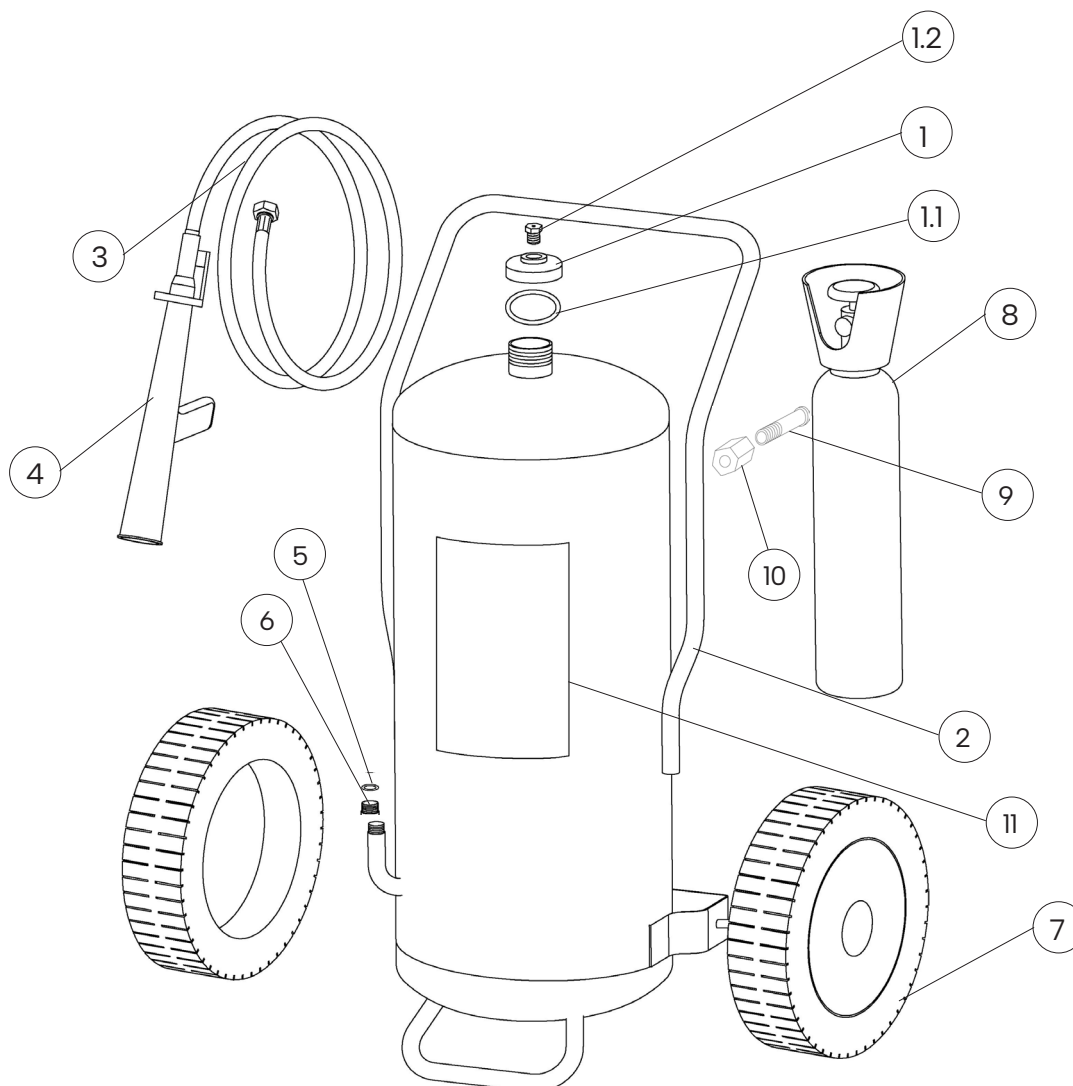

NUM.	DESCRIPTION	CODE
1	Brass cap 2"	18463
1.1	O-ring cap	n.a.
1.2	Safety device	n.a.
2	Cylinder	18306
3	Hose	18421-3
4	Dispensing nozzle (complete of ball valve with control lever)	2181
5	Bursting disk	0262-4
6	Copper washer	2148-11

NUM.	DESCRIPTION	CODE
7	Wheel + stopwheel (300mm)	0124
8	Complete external cylinder for pressurization, charged with 1,2 Kg CO ₂ , with protective cap for valve	18519
9	Connection for cylinder ext. ag.	18489
10	Connection for propellant cylinder	18495
11	Label	18392M

The spare part at number 1 includes already all others components 1.1 , 1.2

"n.a." mean that the component is not available as single spare part

File name	Type of document	Fire Extinguisher Model	Date	Rele.	Check	Rev.	Pag.
16508-52_ technical manual	technical manual	16508-52	27/05/2025	S.R		3	3/3